

AYMROO PTY.LTD.

1/5 KERR ROAD

INGLEBURN N.S.W.

(02) 9605 8751

FREE FAX 1800 357 551

STEP IRONS

MATERIAL:- uP.V.C.

DRG. No.: ESP N0.21

DRAW:

CHECK;

DATE: 01.04.2001

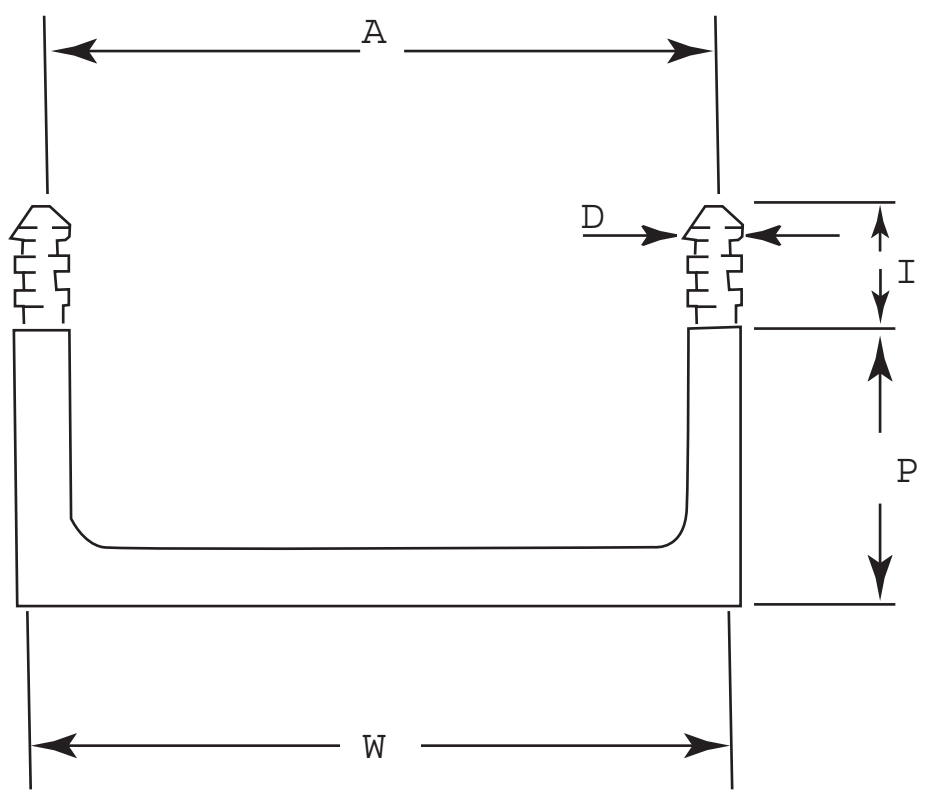

STEP IRONS

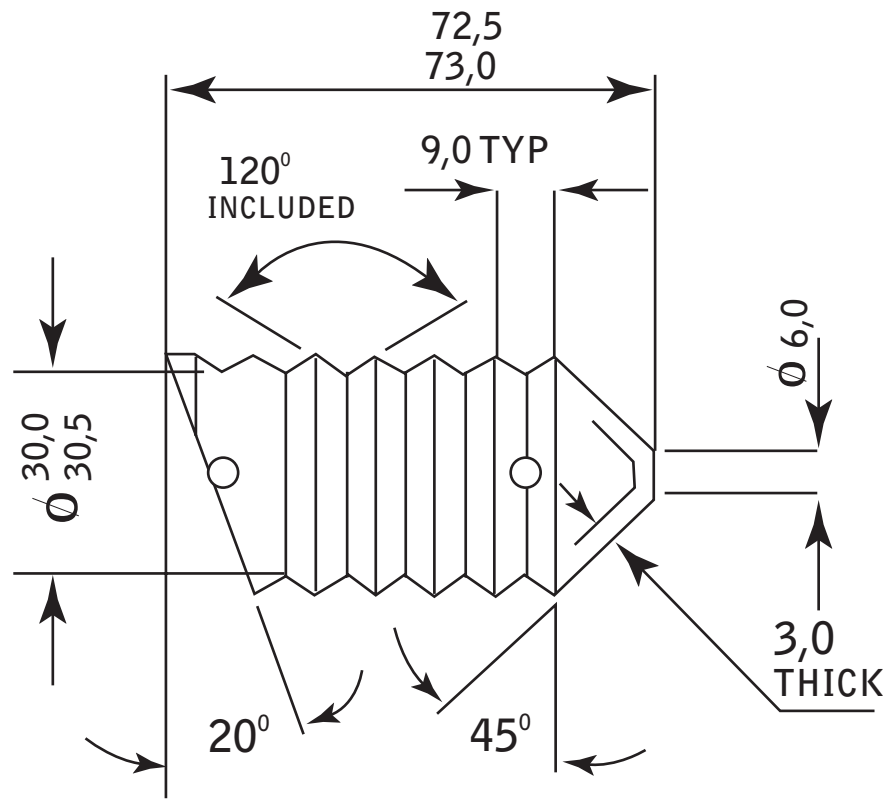

LEG INSERT

SIZES	HK				SYD
HOLE CENTRE (A)	132mm	225mm	375mm	400mm	175mm
WIDTH (W)	150mm	238mm	383mm	408mm	150mm
PROJECTION (P)	150mm	175mm	175mm	175mm	168mm
DIAMETER (D)	25mm	25mm	25mm	25mm	25mm
INSERTION DEPTH (I)	55mm	65mm	65mm	65mm	65mm
WEIGHT	760gms	892gms	1104gms	1120gms	760gms